

INSTRUCTION MANUAL
FOR THE
MITRE-Mite Disk Sander ®
PICTURE FRAMERS - SANDING DISK TOOL

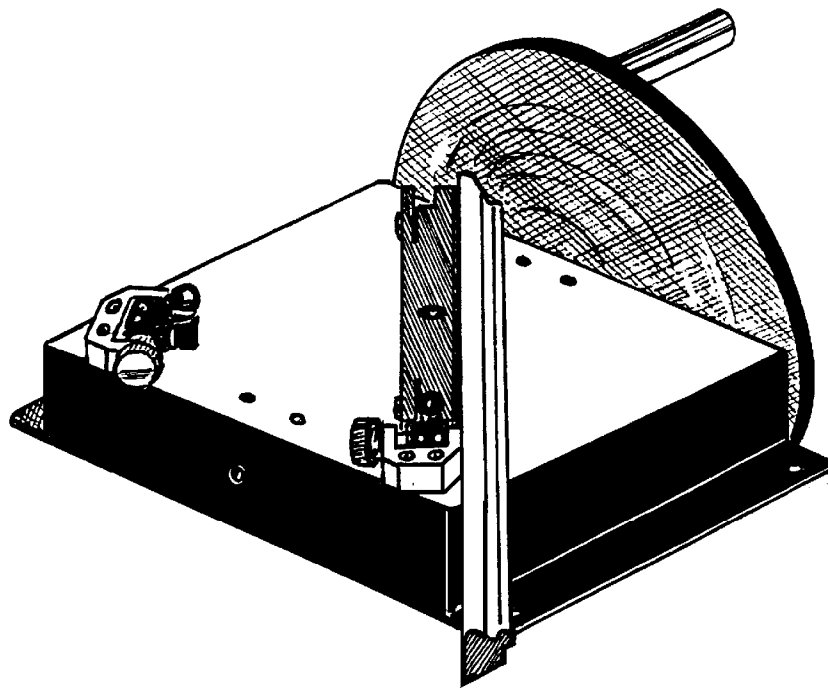

ITWAMP

An Illinois Tool Works Company

100 Fairway Drive Suite 114 - Vernon Hills - IL. 60061

TEL: 800-322-4204 FAX: 800-426-7019

1. UNPACKING YOUR SANDER:

Remove the machine from the carton. Check for any shipping damage and report any damage *immediately* to the Freight Carrier. Save the carton & inside packing in case it is necessary to re-ship your machine. If packaging was opened, check for any missing parts. They should include:

- a) Three (3) 12" abrasive disks
- b) One (1) abrasives-cleaning block
- c) Metric Allen wrenches
- d) One (1) 45° Template
- e) Four (4) Lag Bolts

2. SETTING UP YOUR SANDER:

A) Bolt the machine to a table or workstand with the 4 lag bolts supplied. Do not attempt to work with this machine just *sitting* on a table surface.

B) Lay the disk down on work surface with handle over the edge. Thoroughly **clean** the protective oil film from the steel disk, using a solvent such as mineral spirits, lacquer thinner or a product like UNSEAL. This VERY IMPORTANT!

C) Remove the paper backing just over half way from the abrasive disk. Fold the release liner over and hold abrasive disk by that side. By laying the liner side of the abrasive disk on top of the disk plate, you can align the edge of each disk. When properly aligned, press on the side of the abrasive disk that has no liner under it. Now, holding down on the stuck side, slowly remove the remainder of the liner and press the entire abrasive disk onto steel plate.

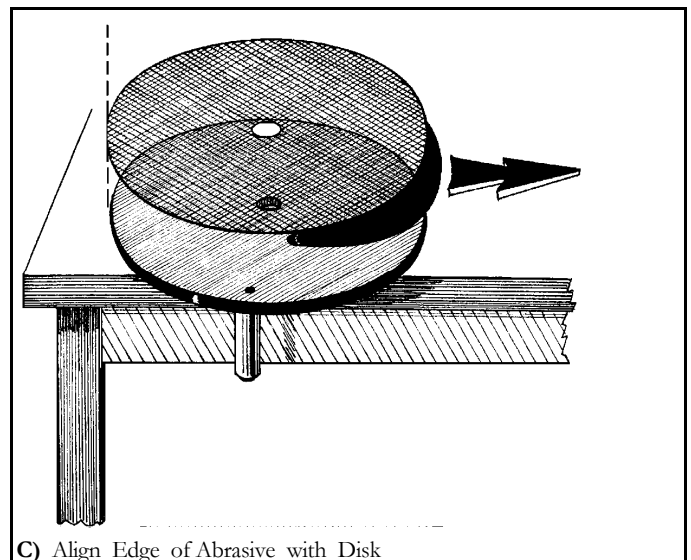
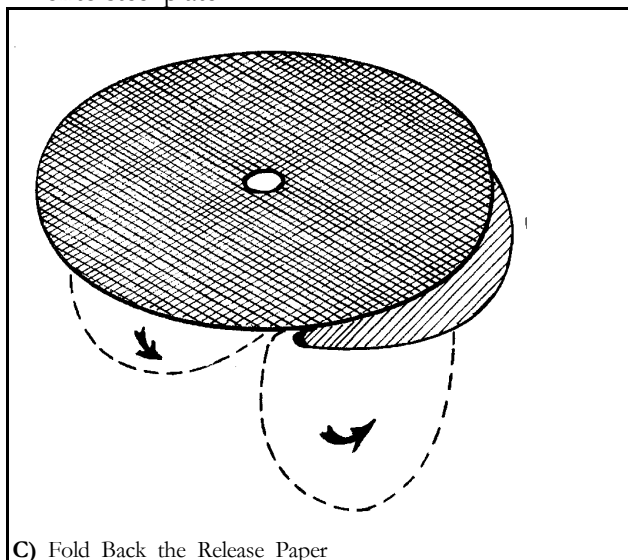
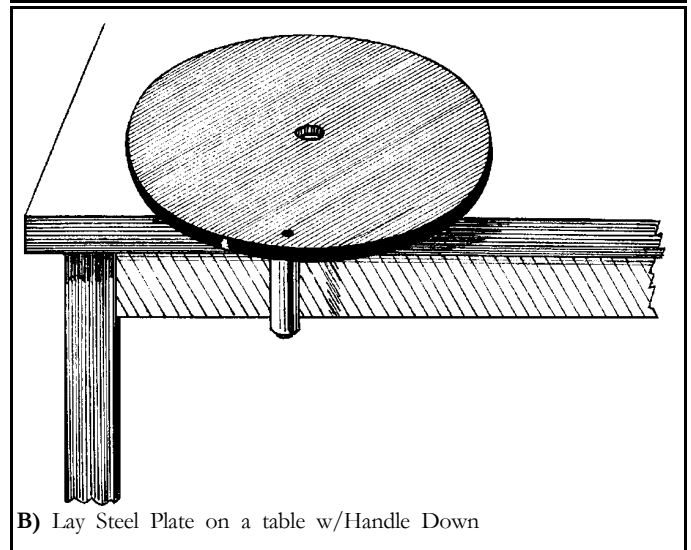
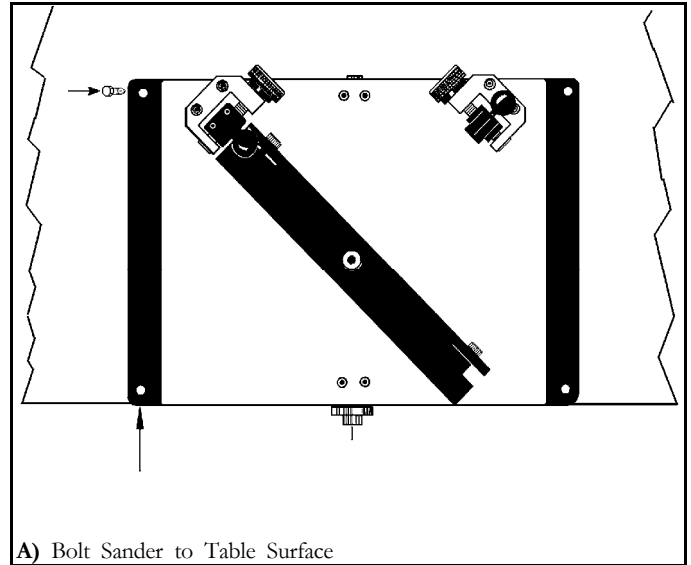

2. SETTING UPContinued:

- D) Install the disk plate with abrasive onto the sander center shaft. Engage the screw and washer by hand, then tighten with the 8mm allen wrench that's supplied. Hold onto the handle while tightening the allen screw.

3. ADJUSTING THE 45° ANGLE:

- A) First set the fence to the left side as shown in the illustration at right. Lock the Flip Stop Lever down into the fence slot. Set the 45° template to the left of the fence and slide it down to the disk plate. If there is no gap along the disk plate surface or along the fence, then the angle is set properly at **exactly** 45°.
- B) If there is movement with the template, then take the following steps to correct the angle for that side.
- 1: Use the smallest allen wrench and loosen the locking adjustment set screw, located on the top of the adjusting bracket for each side. (see detail below LEFT)
 - 2: While keeping the template against the fence, and loosely against the disk plate, turn the adjusting knob until the template is aligned perfectly with *both* the **fence** and the **disk plate**.
 - 3: Retighten the locking adjustment screw.
 - 4: Release the Flip Stop and swing the fence to the opposite side. Repeat steps 1 - 3 to correct any misalignment in the other side.

NOTE: When making these adjustments, the Flip Stop **must** be down (engaged) into the fence slot. Since the Flip Stop is pivoting on a threaded shaft, there is a slight movement of the fence during the engagement arc. If there is any play in either flip stop movements, tighten the (2) screws that hold the stops onto the threaded shafts, until there is no side play, but the stops rotate without binding.

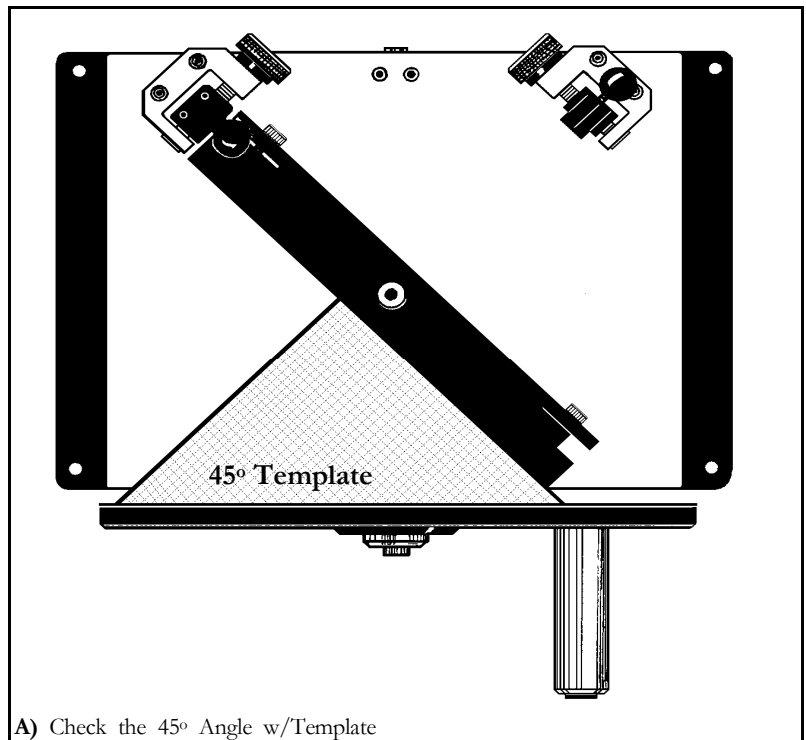
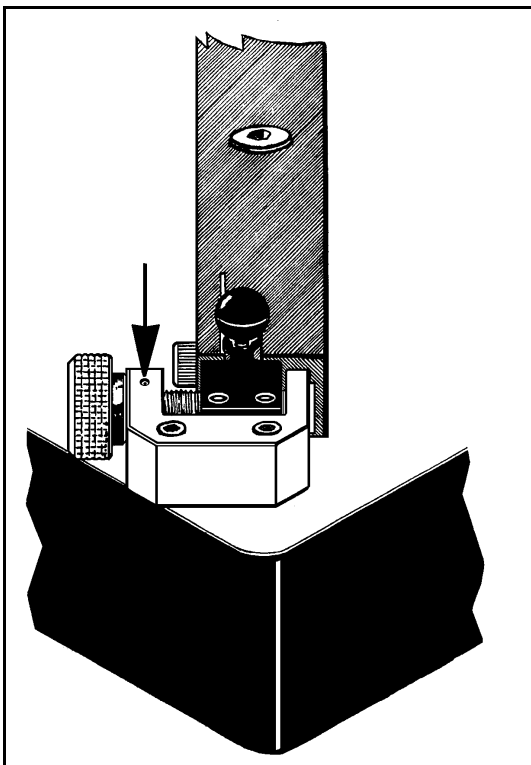
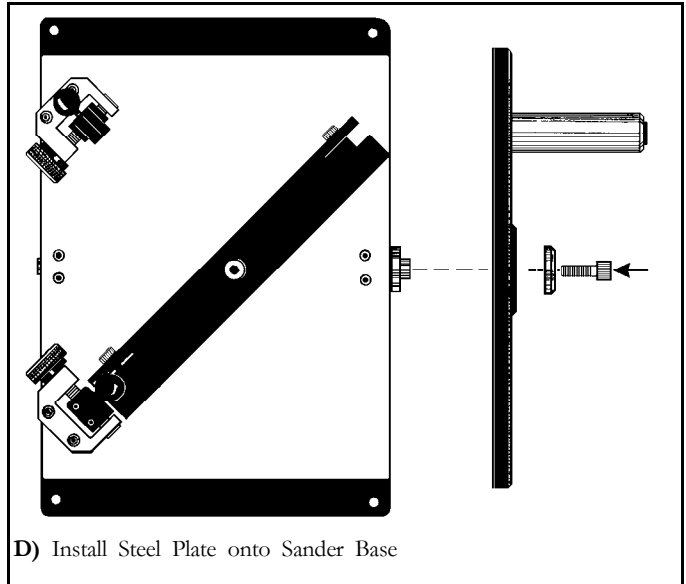

4. USING YOUR SANDER:

Now that the angles are precisely set at 45° for each side, do the following steps to get a perfectly sanded corner.

A) Place frame rail against fence and slide mitred end up to the sanding disk surface. Use a *slight* hand pressure to hold the rail against the adhesive disk face.

B) With your other hand, grasp the rotating handle on the disk plate and rotate the disk in the direction of the fence. **This is very important !**

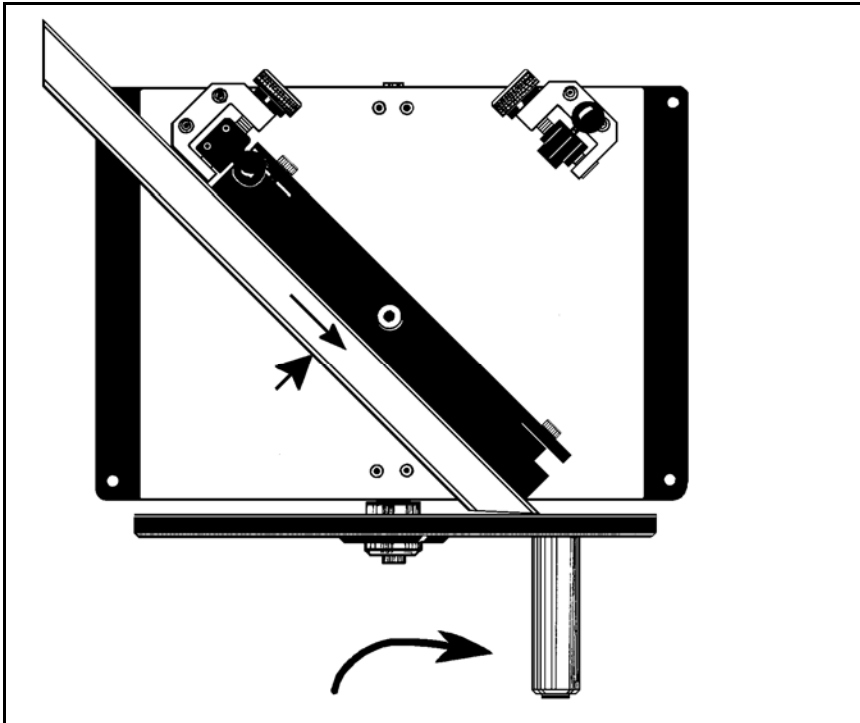

The disk should be coming *down* onto the top of the mitred edge, forcing it into the table and fence.

Rotate the disk 4-5 times and check the mitre end to see if sanding has occurred completely across the cut. If sanding is complete, the mitre should be true. If not complete, repeat sanding process until the mitre is completely sanded and the cut end is "trued up".

When the fence is facing *right* as pictured (in this first example), the handle is rotated to the *right*.

When the fence is facing *left*, as pictured (in the second example), the handle is rotated to the *left*.

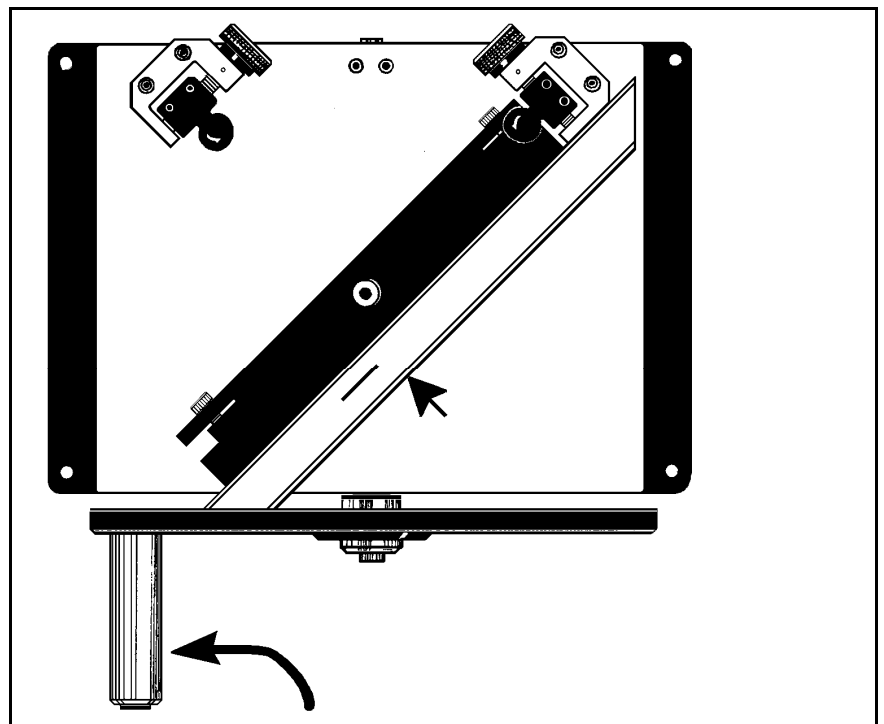

5. CLEANING THE ABRASIVE SURFACE:

After repeated use, the abrasive surface can become filled up or "clogged" from sawdust and gesso particles. You should not replace the abrasive disk at this point. The sander has been supplied with a rubber cleaning block which should be used to "clean" the surface. Hold the cleaning block at an angle so that just one edge is touching the disk plate abrasive. Use very light pressure, and slowly turn the disk plate. The particles clogging the surface should start to fall off. Continue until they stop dropping.

NOTE: After cleaning, the surface may not *LOOK* clean. Discoloration is normal on the surface of the disk where it has been used. The discoloration doesn't have to disappear for the "**grit**" to be clean. The whitish coloring will be trapped in the backing material, even after the surface is cleaned.

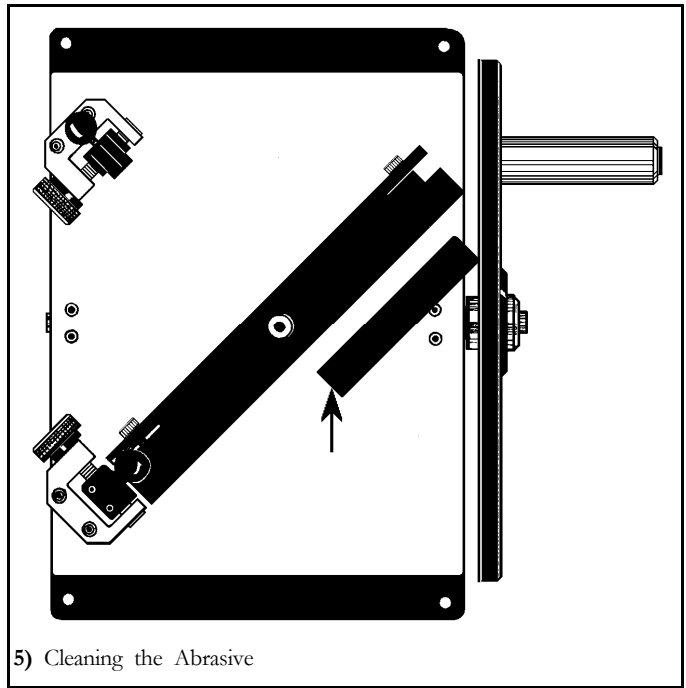

IMPORTANT DO'S AND DON'Ts:

- DO NOT - OPERATE THE SANDER WITHOUT FASTENING IT TO A WORK TABLE.
- DO - ROTATE SANDING DISK TOWARDS THE FENCE.
- DO - KEEP SANDER PLATE & FENCE CLEAN OF DUST & DIRT (FOR ACCURACY)
- DO - KEEP SANDING DISK CLEAN WITH CLEANING BLOCK.
- DO - KEEP HANDS & CLOTHING AWAY FROM DISK SURFACE WHEN ROTATING.

LIMITED WARRANTY:

The manufacturer warrants this equipment to the original Purchaser to be free from defects in material or workmanship for a period of one (1) year from the date of purchase on all mechanical parts. (Abrasive disks & cleaning block not included.) This Limited Warranty shall be limited to the repair or replacement, at the sole discretion of Manufacturer, of any defective part or parts. In the event of a defect in material or workmanship within the period of this Limited Warranty, Purchaser shall return the defective equipment to Manufacturer's Warranty Service Center, with transportation PREPAID. Proof and Date of Purchase **will be required** on any product so associated with any Warranty Claim.

Failure of this equipment caused by accident, corrosion, misuse or abuse of the equipment including but not limited to, damages or defects resulting from improper packaging of returned equipment or improper repairs made by others, is not covered by this Limited Warranty. Manufacturer reserves the right to determine whether the defect is covered by this Limited Warranty. If Manufacturer determines that the returned equipment is not covered by this Limited Warranty, then at Purchaser's option, such equipment shall be either: 1) returned to Purchaser, Transportation COLLECT, or 2) repaired or replaced on the basis of Manufacturer's regular repair, replacement, or reconditioning charges, which charges shall be payable by Purchaser, C.O.D. This Limited Warranty extends only to the initial Purchaser and may not be transferred to subsequent owners.

THIS LIMITED WARRANTY IS IN LIEU OF ALL OTHER WARRANTIES, EXPRESS OR IMPLIED INCLUDING ALL IMPLIED WARRANTIES OF MERCHANTABILITY AND FITNESS FOR A PARTICULAR USE AND PURPOSE.

PURCHASER AGREES THAT THE SOLE AND EXCLUSIVE REMEDY AGAINST MANUFACTURER SHALL BE LIMITED TO THE REPAIR OR REPLACEMENT OF DEFECTIVE PARTS. PURCHASER FURTHER AGREES THAT NO OTHER REMEDY, INCLUDING BUT NOT LIMITED TO INCIDENTAL OR CONSEQUENTIAL DAMAGES FOR LOST PROFITS, LOST SALES, INJURY TO PERSON OR PROPERTY, OR ANY OTHER INCIDENTAL OR CONSEQUENTIAL LOSS, SHALL BE AVAILABLE TO IT, AND, IN ANY EVENT, THE LIABILITY OF MANUFACTURER FOR ANY DAMAGES SHALL BE LIMITED TO THE PURCHASE PRICE OF THE EQUIPMENT.

ITWAMP
100 Fairway Drive Suite 114
Vernon Hills, IL. 60061

Disk Sander

DWG Nr. DS 101

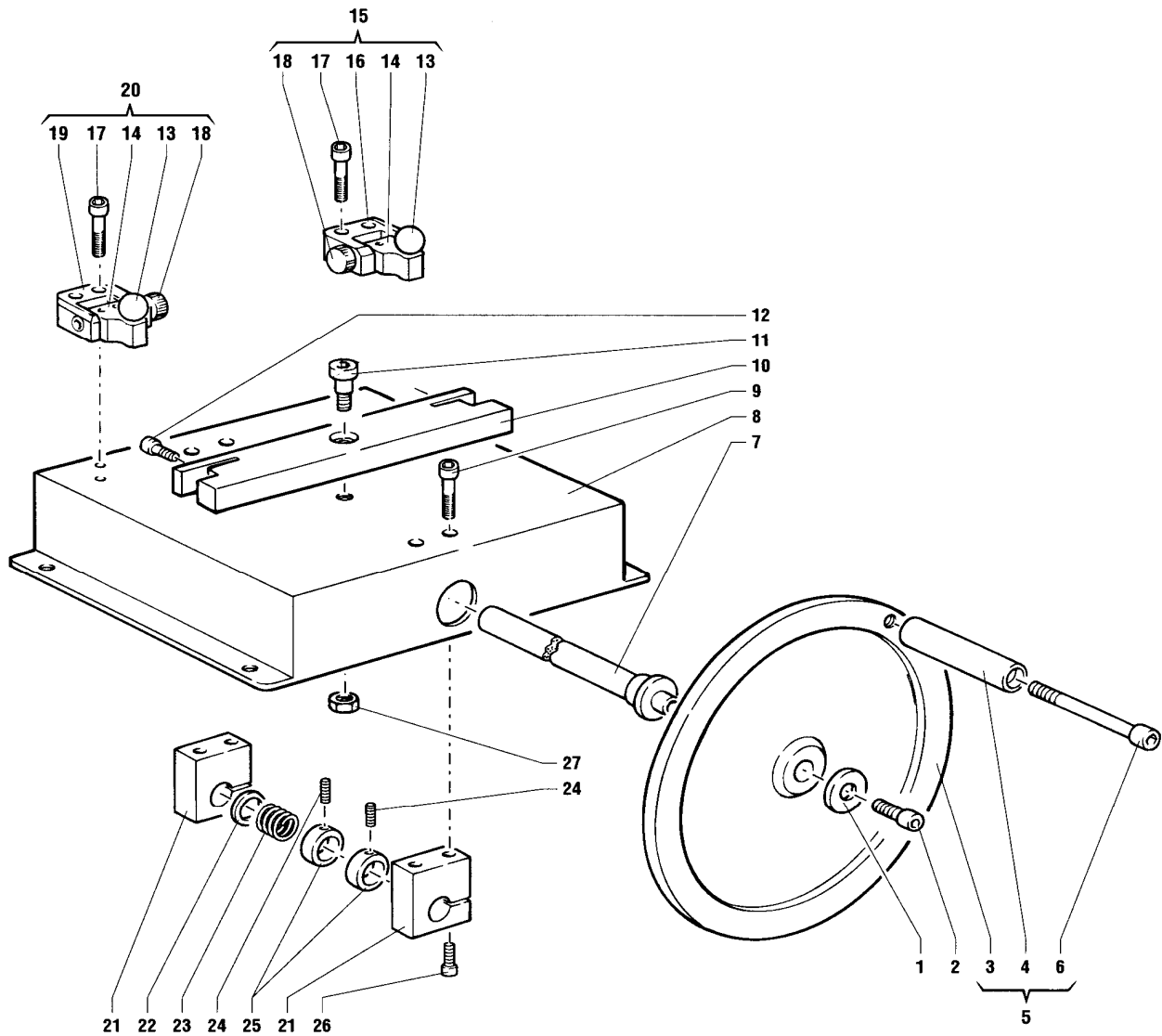

Ref.	Code Number	Q.ty	Descrizione	Description
1	336100160	1	Rondella	Washer
2	710100151	1	Vite	Screw
3	332980010	1	Volano	Flywheel
4	334000110	1	Maniglia	Handle
5	242980010	1	Volano completo	Complete flywheel
6	710100191	1	Vite	Screw
7	241700010	1	Albero	Shaft
8	211250180	1	Carcassa	Casing assembly
9	710100075	4	Vite	Screw
10	376400070	1	Traversa	Support
11	710100149	1	Vite speciale	Screw
12	710100080	2	Vite	Screw
13	753270001	2	Pomello	Knob
14	381300720	2	Supporto	Support
15	243770010	1	Staffa di regolazione completa (DX)	Right adjusting bracket complete
16	393770010	1	Forcella DX	Fork "DX"
17	710100079	4	Vite	Screw
18	331700030	2	Albero	Shaft
19	393770020	1	Forcella SX	Fork "SX"
20	243770020	1	Staffa di regolazione completa (SX)	Left adjusting bracket complete
21	383900180	2	Supporto di guida	Support
22	337500110	1	Rondella	Washer
23	765000012	1	Molla	Spring
24	714300015	2	Grano	Headless screw
25	336100170	2	Rondella	Washer
26	710100078	2	Vite	Screw
27	715350002	1	Dado	Nut