

LASERMAX LX500



LX550 Unwinder

The LASERMAX LX550 Unwinder feeds a roll of paper, up to 20.5" wide and 52" in diameter, into a printer or inserter at speeds up to 600 feet per minute. It is based on the print industry standard of a center-shaft drive mechanism making it the most accurate and reliable roll-feed system available. It uses a new CPU capable of remote diagnostics and enhanced error recovery. In addition, it uses the new UP3I interface standard for intelligent communication between all machines and the printer. The LX550 Unwinder has an attractive ergonomic design with an interactive, touch-screen display for greater ease of use. The display now includes the LX500 Support System which provides error detection along with step-by-step instructions designed to quickly guide in operator troubleshooting. Its integrated splice station works with both pinfed and pinless paper.

Benefits of the LASERMAX LX550 Unwinder

- Quick loading and changing of rolls
- Center-shaft driven—no surface contact with forms
- Compatible with pressure sensitive labels
- Ability to feed directly into inserters
- Attractive ergonomic design
- Low profile—unobstructed view of operation
- Easy to use splice station
- No exposed "pinch points" for maximum safety
- Positive locking feature for airshaft—no operator adjustments

Standard features of the LASERMAX LX550 Unwinder

- LX500 Support System included in touch-screen display
- Internal triple loop
- New CPU
- UP3I compliance
- Increased speed—up to 600 ft/min
- Interactive touch-screen display
- Automatic end of roll detector

Technical Specification

LX550 Unwinder

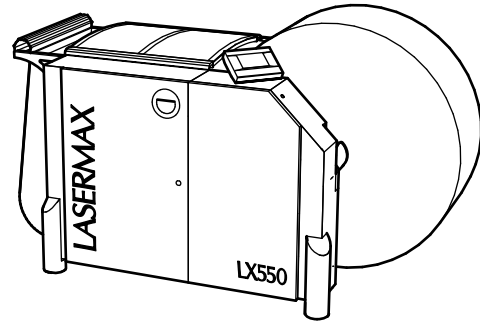

General

Print	Simplex or duplex	
Paper feeding	Pinfed or pinless	
Roll diameter	4"-52"	100 mm-1320 mm
Web width	6"-20.5"	155 mm-520 mm
Weight of roll	Max. 1389 lb	630 kg
Paper weight	40-200 gsm	
Web speed	100-600 ft/min	0.5-3.0 m/s
Approvals	CE (98/37/EG), EMC Class A, LVD, CB EN 60950, cULus 1950 3rd, FCC15 Class A, VCCI	
Color	Grey	

Electrical

North America	15A, 1 Phase, 208 V, REC=L6-15R	
Other Countries	10A, 200-240 (+6% -10%) VAC 1-50/60Hz	
Power consumption	Standby 120 W	Running 500 W
Heat emission	300 kcal/h, 1200 kJ/h, 1150 BTU	

Environment

Operating noise	65 dB(A)
Rel. humidity	50 +10%

Physical

Length incl loop	72"	1825 mm
incl loop & max paper roll	91"	2310 mm
Width	41.5"	1050 mm
Height excl. display	45.5"	1155 mm
Weight	1587 lb	720 kg

Service Area

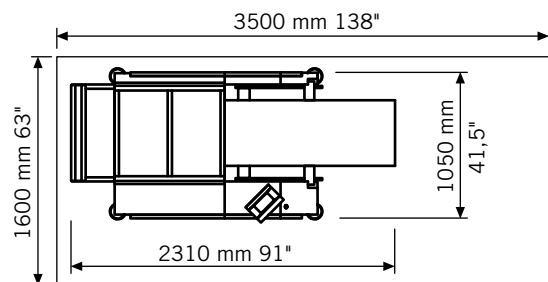

Options

Airshafts	70 mm, 150 mm, 200 mm, 3", 5" and 6"
Interface	To all printers
Low speed kit	For use with low speed printers 0.1- 0.5 m/s 20 - 100 ft/min
Trolley	For paper rolls
Splice sensor	To detect splice in paper roll
Fan	To control paper loop
Wheels	To move the unwinder
Rollstop sensor kit	

Lasermax Roll Systems reserves the right to make any technical amendments without prior notification.